



Douglas Barwick Inc.

Stainless Steel Piping

Tuyauterie en Acier Inoxydable

IPS ELBOWS

COUDES IPS

**ASME SA 403 / ASTM A 403
WP-W, WP-WX, CR**

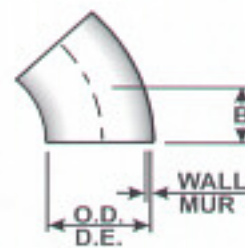
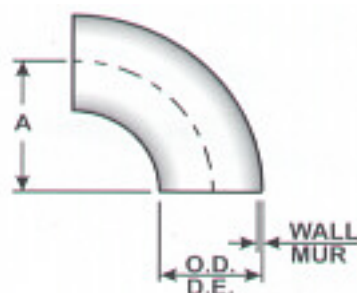

DIA. (NOM.)		O.D. / D.E.		Schedule 10S						Schedule 40S						A		B	
IN.	mm	IN.	mm	WALL / MUR		90°		45°		WALL / MUR		90°		45°		IN.	mm	IN.	mm
				PO.	mm	lb	kg	lb	kg	PO.	mm	lb	kg	lb	kg				
3	75	3.5	89	0.120	3.0	3	1.4	1.5	0.7	0.216	5.5	5	2.3	2.5	1.1	4.5	114	2	51
4	100	4.5	114	0.120	3.0	5	2.3	2.5	1.1	0.237	6.0	9	4.1	4.5	2.0	6	152	2.5	63
6	150	6.62	168	0.134	3.4	12	5.1	6.0	2.7	0.280	7.1	22	10.0	11.0	5.0	9	229	3.75	95
8	200	8.62	219	0.148	3.7	22	10.0	11.0	5.0	0.322	8.2	43	19.5	21.5	9.8	12	305	5	127
10	250	10.75	273	0.165	4.2	39	17.7	19.5	8.8	0.365	9.3	80	36.3	40.0	18.1	15	381	6.25	159
12	300	12.75	324	0.180	4.6	60	27.2	30.0	13.6	0.375	9.5	112	50.8	56.0	25.4	18	457	7.5	190
14	350	14.0	356	0.188	4.8	89	40.4	44.5	20.2	0.375	9.5	178	80.7	89.0	40.3	21	533	8.75	222
16	400	16.0	406	0.188	4.8	115	52.2	57.5	26.1	0.375	9.5	230	104.3	115.0	52.2	24	610	10	254
18	450	18.0	457	0.188	4.8	149	67.6	74.5	33.8	0.375	9.5	298	135.2	149.0	67.6	27	686	11.25	286
20	500	20.0	508	0.218	5.5	207	93.9	103.5	46.9	0.375	9.5	356	161.5	178.0	80.7	30	762	12.5	317
24	600	24.0	611	0.250	6.3	354	160.6	177.0	80.3	0.375	9.5	531	240.4	265.0	120.5	36	914	15	381

NOTES

1. Wall tolerance to ASTM A 403.
2. Material: Stainless steel 304L - 316L.
Other alloys available upon request.
3. Supplied with beveled ends to ASME B16.9.

1. Tolérance des murs selon ASTM A 403.
2. Matériau: acier inoxydable 304L - 316L.
Autres alliages disponibles sur demande.
3. Les bouts sont fournis biseautés selon ASME B16.9.



Douglas Barwick Inc.

Stainless Steel Piping

Tuyauterie en Acier Inoxydable

IPS REDUCERS

REDUCTEURS IPS

ASME SA 403 / ASTM A 403
WP-W, WP-WX, CR

CONICAL
CONIQUE
(NOTE 4)

BELL TYPE
PAROI BOMBÉE



CONCENTRIC
CONCENTRIQUE

ECCENTRIC
EXCENTRIQUE

CONCENTRIC
CONCENTRIQUE

ECCENTRIC
EXCENTRIQUE

DIA. (NOM.)		O.D. / D.E.		A		Schedule 10S				Schedule 40S			
INCHES	mm	INCHES	mm	INCHES	mm	WALL / MUR		WEIGHT / POIDS		WALL / MUR		WEIGHT / POIDS	
pouces		pouces		pouces		INCHES pouces	mm	LB	kg	INCHES pouces	mm	LB	kg
3	75	3.50	89	3.5	89	0.120	3.0	1.0	0.5	0.216	5.5	1.9	0.9
4	100	4.50	114	4.0	102	0.120	3.0	1.7	0.8	0.237	6.0	3.2	1.4
6	150	6.62	168	5.5	140	0.134	3.4	3.6	1.7	0.280	7.1	7.3	3.3
8	200	8.62	219	6.0	152	0.148	3.7	6.0	2.7	0.322	8.2	12.6	5.7
10	250	10.75	273	7.0	178	0.165	4.2	10.0	4.6	0.365	9.3	21.5	9.7
12	300	12.75	324	8.0	204	0.180	4.6	15.5	7.1	0.375	9.5	30.6	13.9
14	350	14.0	356	13.0	330	0.188	4.8	28.9	13.1	0.375	9.5	56.3	25.5
16	400	16.0	406	14.0	356	0.188	4.8	35.5	16.1	0.375	9.5	70.2	31.8
18	450	18.0	457	15.0	381	0.188	4.8	43.2	19.6	0.375	9.5	85.5	38.8
20	500	20.0	508	20.0	508	0.218	5.5	75.0	34.0	0.375	9.5	128.0	57.9
24	600	24.0	610	20.0	508	0.250	6.3	99.8	45.2	0.375	9.5	148.0	67.3



Douglas Barwick Inc.

Stainless Steel Piping

Tuyauterie en Acier Inoxydable

STUB ENDS TYPE A

COLLETS "STUB-END" TYPE A

**ASME SA 403 / ASTM A 403
WP-W, WP-WX, CR**

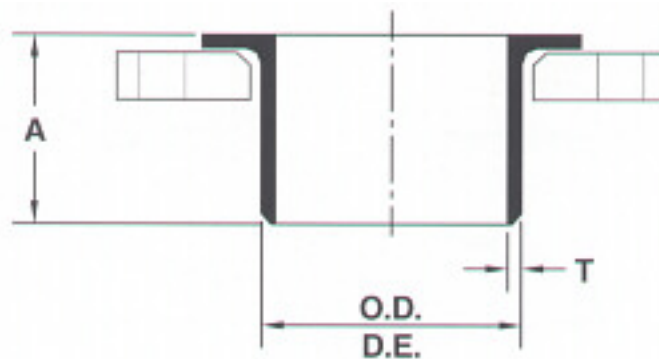

DIA. (NOM.)		O.D. / D.E.		A		Schedule 10S			
INCHES	mm	INCHES	mm	INCHES	mm	WALL / MUR		WEIGHT / POIDS	
pouces		pouces		pouces		INCHES pouces	mm	LB	kg
3	75	3.50	88.9	2.5	63.5	0.120	3.0	1.3	0.6
4	100	4.50	114.3	3.0	76.2	0.120	3.0	2.0	0.9
6	150	6.62	168.3	3.5	88.9	0.134	3.4	3.8	1.7
8	200	8.62	219.1	4.0	101.6	0.148	3.7	5.8	2.6
10	250	10.75	273.0	5.0	127.0	0.165	4.2	9.9	4.5
12	300	12.75	323.8	6.0	152.4	0.180	4.6	15.2	6.9
14	350	14.0	355.6	6.0	152.4	0.188	4.8	20.3	9.2
16	400	16.0	406.4	6.0	152.4	0.188	4.8	22.9	10.4
18	450	18.0	457.2	6.0	152.4	0.188	4.8	25.7	11.6
20	500	20.0	508.0	6.0	152.4	0.218	5.5	33.1	15.0
24	600	24.0	610.6	6.0	152.4	0.250	6.3	44.7	20.3

NOTES

1. Wall thicknesses are nominal.
2. Material: Stainless steel 304L - 316L.
Other alloys available upon request.

1. L'épaisseur des murs est nominale.
2. Matériau: acier inoxydable 304L - 316L.
Autres alliages disponibles sur demande.